

Inset helipad lights **AV-HLI2** are an excellent choice for locations where elevated lights are not suitable or can cause interference to passing aircraft and maintenance vehicles.

Key Features:

- Optimised light output with optional IR
- Compact and low profile, <10mm (0.4")
- Integration Optimised in elevated helipads
- Fully sealed optics and electronics
- Safe Extra Low Voltage compliant
- Existing infrastructure compatible

Optional



Controller



IR



Mounting



Solar



IR available

The lights can be dimmed to reduce glare and are available with optional infrared (IR) visibility for pilots using night vision.

Robust Construction

Able to withstand the harshest environments, the unit is made from robust, corrosion-resistant anodised aluminium with a UV-stabilised lens with excellent impact resistance, thermal stability and transparency. The electronics are fully encapsulated for further protection.

High efficiency LEDs with over 100,000 hour life expectancy are used ensuring the lights are long lasting and low maintenance.

Plug & Play Design

The inset helipad lights are compatible with existing infrastructure and come with a simple plug and play connection making them simple to install.

Optional Heliport Lighting System

An optional Heliport Lighting Control (AV-HL-CTRL) can be supplied and integrated with the inset helipad lights to provide central control and/or remote operation functionality for a variety of helipad operations.

ICAO Compliant

Designed to meet the standards of ICAO Annex 14 Volume 2 and FAA Engineering Brief 87 Heliport Perimeter Light for Visual Meteorological Conditions.



AV-HLI2_DATA_EN_V5.1



Light Characteristics

Light Source	LED
Available Colours	Green, White, Yellow, Blue, Red, IR
Peak Intensity - Visible (cd)	Complies to: ICAO Annex 14 Vol 2., FAA EB 87, CAP 437
Peak Intensity - IR (mW/str)	240
Intensity Adjustments	Visible Option: 0 to 100% dimmable IR Option: IR continuous on, with LCMS and IR switchable
LED Life Expectancy (hours)	> 100,000

Electrical Characteristics

Circuit Protection	Integrated
Operating Voltage	18 – 30 V
Power (W)	<div> <div> TLOF-G Green 5.3W ADI-W White 5.3W FATO-W White 9.6W TLOF-Y Yellow 5.3W TLOF-B Blue 5.3W TLOF-R Red 5.3W </div> <div> TLOF-G-NVG Green IR 5.5W ADI-W-NVG White IR 5.5W FATO-W-NVG White IR 9.9W TLOF-Y-NVG Yellow IR 5.5W TLOF-B-NVG Blue IR 5.5W TLOF-R-NVG Red IR 5.5W </div> </div>
Temperature Range	-40 to 55°C (-40 to 131°F)
Transport and Storage Temperature Range	-40 to 85°C (-40 to 185°F)

Physical Characteristics

Body Material	Corrosion resistant anodised aluminium
Lens Design	LED optic
Mounting	4 x M5 Screws
Height (mm/inches)	160 / 6.30
Width (mm/inches)	190 / 7.48
Mass (kg/lbs)	0.9 / 1.98
Service Life	Up to 12 years

Environmental Standards

Shock	MIL-STD-202G, Test Condition G, Method 213B
Vibration	MIL-STD202G, Test Condition B, Method 204
Wind Speed	Up to 160kph / 100mph
Humidity	0 to 100%, MIL-STD-810F

Compliance

ICAO	ICAO Annex 14, Vol 1, July 2018
EMC	EN61000-6-4:2012, EN61000-6-2:2019
Quality Assurance	ISO9001:2015
Waterproof	IP68
Trademarks	AVLITE® is a registered trademark of Avlite Systems

Other

Warranty *	2 year warranty
Options Available	AC/DC converter for AC/DC Variety of solar/battery configurations Adaptor Plate for mounting in 8" Shallow Bases according to IEC TS 61827 / FAA AC 5439/150-46D 5" or 8" Shallow Base LCMS Helipad Control System
Terms and Conditions	Please refer to the light installation manual for further specifications. Warranty Terms and Conditions - www.avlite.com

Technical Illustrations

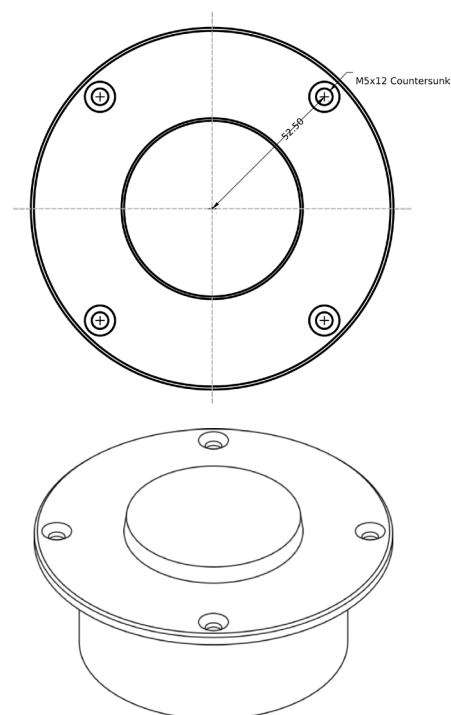
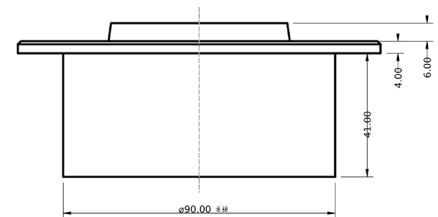

Ordering This Product

AV-HLI2-[XXXX]-5-24-[XXX]



1 Product Number

2 Application

FATO	Final Approach and Take Off
TLOF	Touch Down and Lift Off
AIP	Aim Indicator Point
ADI	Aim Direction Indicator

3 LED Colour

G	Green
W	White
Y	Yellow
B	Blue
GIR	Green Infrared
WIR	White Infrared