



The **AV-SSBL** is a self-contained approach light available in two chassis configurations. It is either powered by solar with an optional AC input only or AC input with battery backup.

### Key Features:

- Composite Polymer Chassis with Integrated Solar Panels and Battery Backup System
- Aluminum Chassis with Internal User-Replaceable Battery

Standard



Battery Backup

Optional



AC Input



Solar



IR Output



Solar Stand-alone  
Steady Burning Light



Hardwired Stand-alone  
Steady Burning Light

### Flexible Configurations

The Stand-alone Steady Burning Light (SBL) can easily integrate into various approach lighting system configurations:

- The MALSR components consist of 6 Steady Burning Barrettes, 15 Stand-alone Steady Burning Lights, and 5 Sequenced Flashing Lights.
- The SSEALS consists of 7 Steady Burning Lights and 3 Sequenced Flashing Lights
- The SALS consists of 17 Stand-Alone Steady Burning Lights.

### Integrated Battery System

The main chassis contains a user-replaceable battery, and can easily add on a solar system option to increase the battery life.

### Applications

- Portable for expeditionary, tactical, or temporary/ semi-permanent use
- IR or NVG mode option for covert operations

### Power Options

Depending upon your requirements, the SBL can be configured with the following power options:

- DC Solar
- AC/Battery Backup
- AC/Battery Backup with Solar

## AV-SSBL

## Solar

## Hardwired

## Light Characteristics

Light Source	LED
Available Colors	White
Intensity Adjustments	3 or 5 step intensity
Operating time at maximum intensity	4 hours
LED Life Expectancy (hours)	> 100,000

## Electrical Characteristics

Circuit Protection	Integrated
Operating Input Voltage	90-264VAC 50/60 Hz
Temperature Range	-40 to 122°F / -40 to 55°C

## Solar Characteristics

Solar Module Type	Monocrystalline	-
Output (Watts)	20 (4 x 5watt)	-
Charging Regulation	MPPT	-

## Power Supply

Battery Type	Sealed Lead Acid (SLA)	
Battery Capacity (Ah)	13.5	25
Nominal Voltage (V)	12	
Charger	Integrated	
Rated Power	45 W	
Input Voltage	90-264VAC 50/60 Hz	

## Physical Characteristics

Body Material	Composite polymer	Painted steel and aluminum
Lens Material	Glass	
Lens Design	Multi-LED optic	
Mounting	2 through-holes with a 200mm circle	
Height (inches/mm)	16.47 / 418	22.01 / 559
Width (inches/mm)	Ø9.20 / 234	Ø9.17 / 233
Mass (lb/kg)	26 / 12	21.98 / 9.97
Service Life	Up to 12 years	

## Environmental Standards

Wind Speed	Up to 300 mph / 483 kph
------------	-------------------------

## Compliance

FAA	FAA-E-2980 Photometrics
Quality Assurance	ISO 9001:2015
Trademarks	AVLITE® and AV-HMALS® are a registered trademark of Avlite Systems

## Other

Warranty *	2 years
Available Options	Infrared
Terms and Conditions	Please refer to product installation manual for further specifications. Warranty Terms and Conditions available at <a href="http://www.avlite.com">www.avlite.com</a> .

## Ordering This Product

AV-SSBL-[XX]-[XX]-[XX]



## 1 Product Number

## 2 Configuration

C0	Compact
C1	Standard
C2	Compact, AC Charging, No PLC, Cyclon Batteries
C3	Compact, AC Charging, No PLC, Haze (SLA) Batteries
C4	Compact, AC Charging, PLC, Cyclon Batteries
C5	Compact, AC Charging, PLC, Haze (SLA) Batteries
C8	Battery Only, AC Charging, No PLC, Cyclon Batteries
C9	Battery Only, AC Charging, PLC, Cyclon Batteries

## 3 Color

FO	FAA Orange
YL	ICAO Yellow
DT	Desert Tan
NG	NATO Green

## 4 Options

00	No Options
02	Infrared



Stand-alone Steady Burning Light



(Solar)

Stand-alone Steady Burning Light



(Hardwired)

Base View

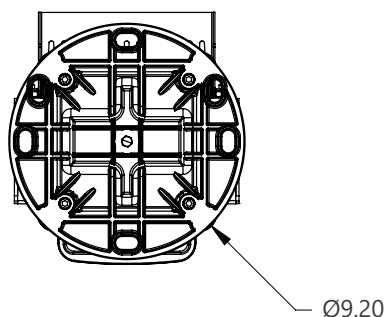

Top View

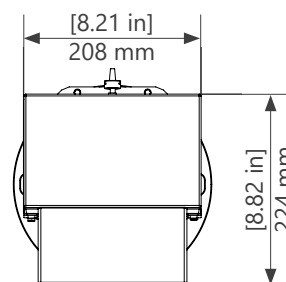

Front View

Side View

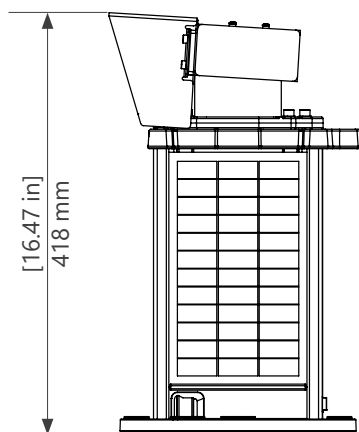
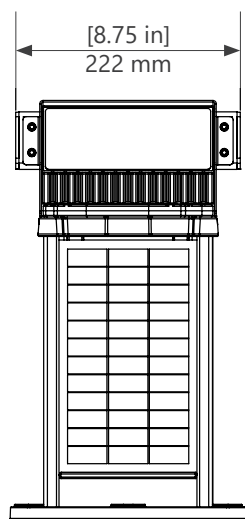

Front View

Side View

